

100 x 50mm timber or other suitable fixing to be fitted by Main Contractor.

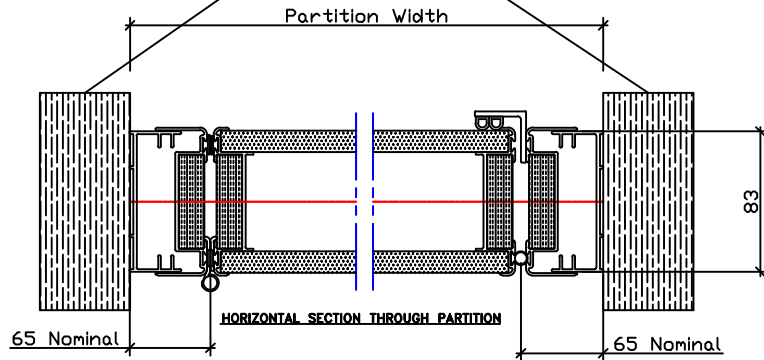

Endfold

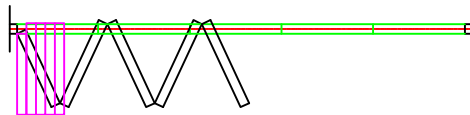

Doors must remain connected (Magnetic Catches) until all panels are fully extended and locked into place.

All necessary supportwork including timber head by others. Tolerance of +/- 2mm on Floor Level.

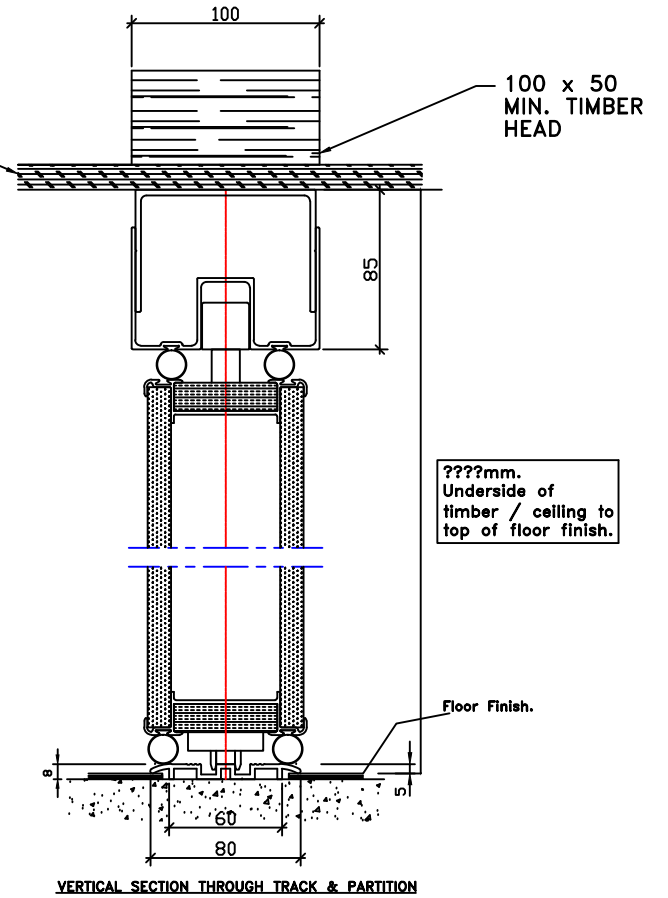

???mm. Underside of timber / ceiling to top of floor finish.

Project:	????						
Product:	Sesam Vikett 85 Floor Mounted Partition.						
Configuration:	Endfold, 1 wing of 4 full panels and 1 end panel.						
Finish:	Duospas LP Laminate.						
Sound Reduction:	??dB (lab value)	Total Weight:	??kgs approx				
Ironmongery:	Latch and Dish Handles	Drawing No.:	???				
Scale:	N.T.S.	Date:	20.12.13	Drawn By:	RLW	Issue:	A
Revisions:	.						

